

Notes

1. AG Subminiature-C 9-pin ceramic connectors are made from Macor machinable ceramic material.
2. Connector socket contacts are not included, and must be purchased separately. Standard and high duty cycle contacts are available as follows...

Contacts 100180 (Standard) or 110908 (High Duty Cycle)... 20 - 24 AWG wire diameters

Contacts 100181 (Standard) or 110909 (High Duty Cycle)... 26 - 30 AWG wire diameters

3. Use AG contact crimping tool No. 100190 for standard contacts.
To crimp high duty cycle contacts add, AG contact positioner No. 111315 to the 100190 crimping tool

Rev	Description	Date
A	Initial Release	

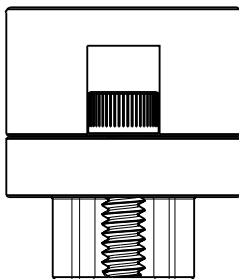

9x
Female socket contacts
.040 pin Diameter
(Not Included)

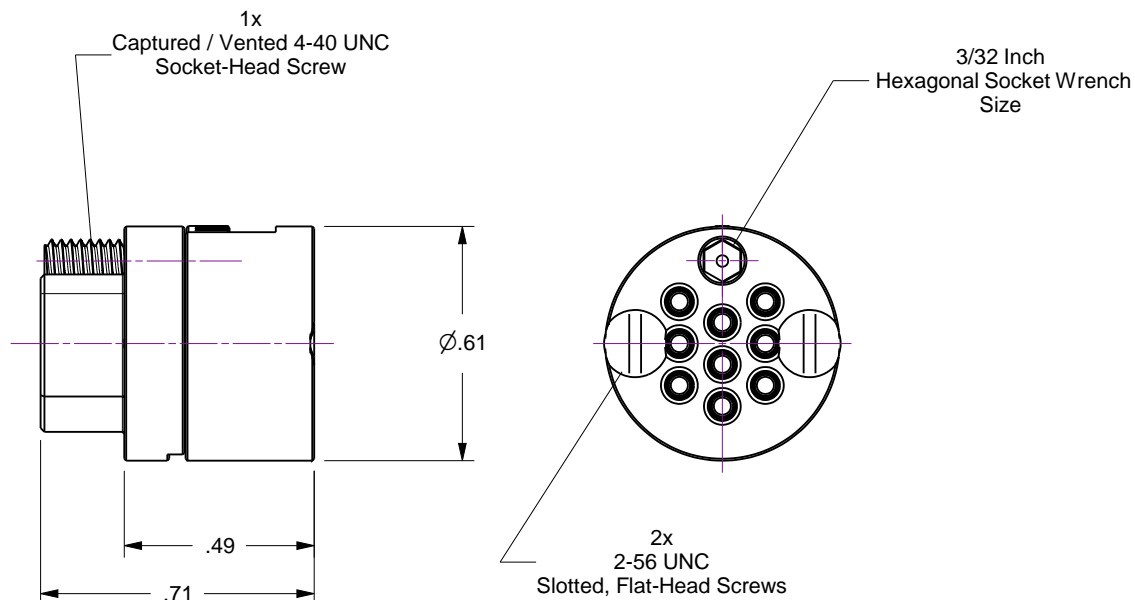

Accu-Glass Products Inc.
25047 Anza Drive
Valencia, CA 91355
T 818-365-4215
F 818-365-7074
www.accuglassproducts.com

UNCONTROLLED WEB DRAWING

Proprietary and Confidential
The information contained in this drawing is the sole property of Accu-Glass, Products Inc. Any reproduction, in part or as whole, without the written permission of Accu-Glass Products, Inc., is strictly prohibited.

Material
See Individual Components

Tolerances,
unless otherwise specified

.X ± .030	Angles ± 0.5° Finish 63Ra
.XX ± .010	
.XXX ± .005	

Title

Connector, 9-Pin Subminiature-C, Female Ceramic

Drawn by	CR	No.	Rev.
Date	11/5/2012	112700	A
Approved			Sheet