

1
2
3
4
PROPRIETARY AND CONFIDENTIAL
THE INFORMATION CONTAINED IN THIS
DRAWING IS THE SOLE PROPERTY OF
ACCU-GLASS PRODUCTS INC. ANY
REPRODUCTION IN PART OR AS WHOLE
WITHOUT THE WRITTEN PERMISSION OF
ACCU-GLASS PRODUCTS INC.IS
PROHIBITED.

Rev	Description	Date	Approved
A	INITIAL RELEASE		

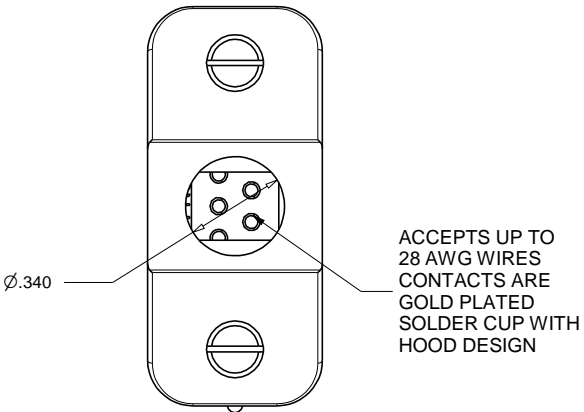
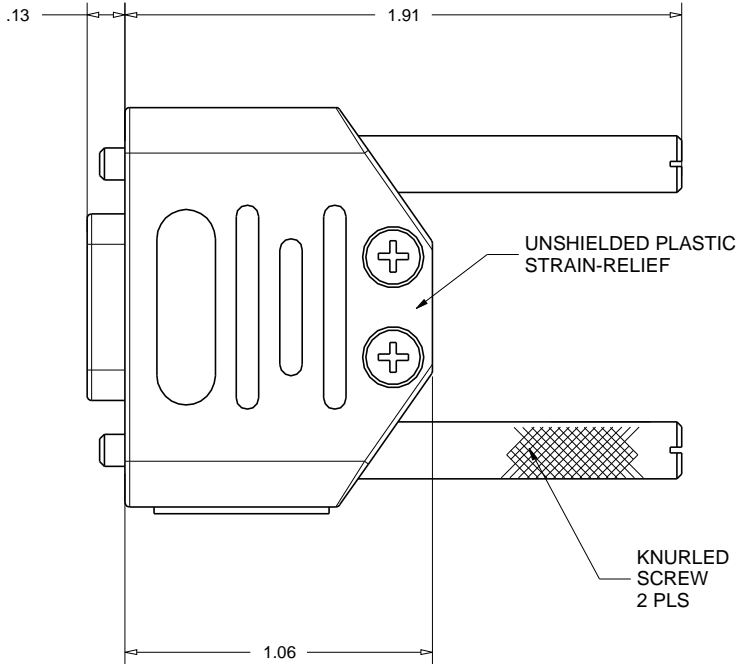
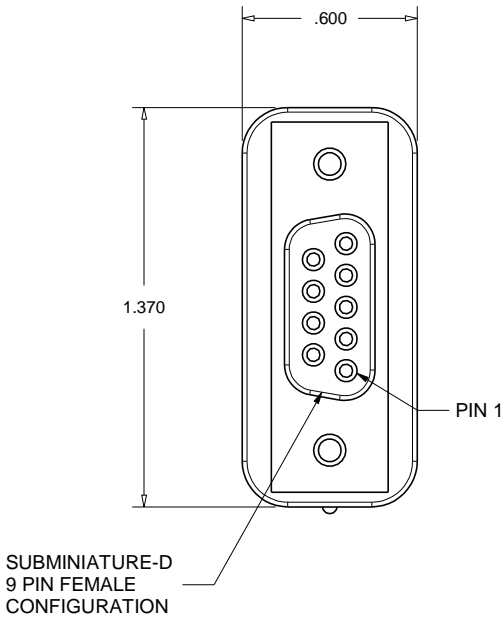
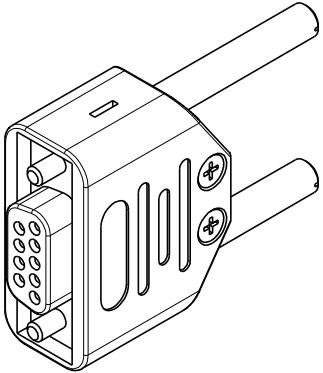

 Accu-Glass Products Inc.
25047 Anza Drive
Valencia, CA 91355
TEL 818-365-4215
FAX 818-365-7074
accuglassproducts.com

Notes:
1. DIMENSIONS SYMMETRICAL ABOUT CENTERLINES

*** UNCONTROLLED WEB COPY ***

Material		Title: 9D-AIR			
assembly		FEMALE 9D AIR SIDE CONNECTOR ASSEMBLY			
Tolerances unless otherwise specified.		Drawn By	CR	DWG. NO.	Rev.
.X ± .03		Date	2/8/2012	103100	A
.XX ± .01		Approved	JAMIE F.	PDFE	Sheet 1 OF 1
.XXX ± .005					
Angular: +/- .5°					
Finish: Min. 63 Ra					